

Greater Norwich Local Plan

Bergh Apton

Legend

 ParishesBoundary

Date created:
31-03-2017

1:21,298



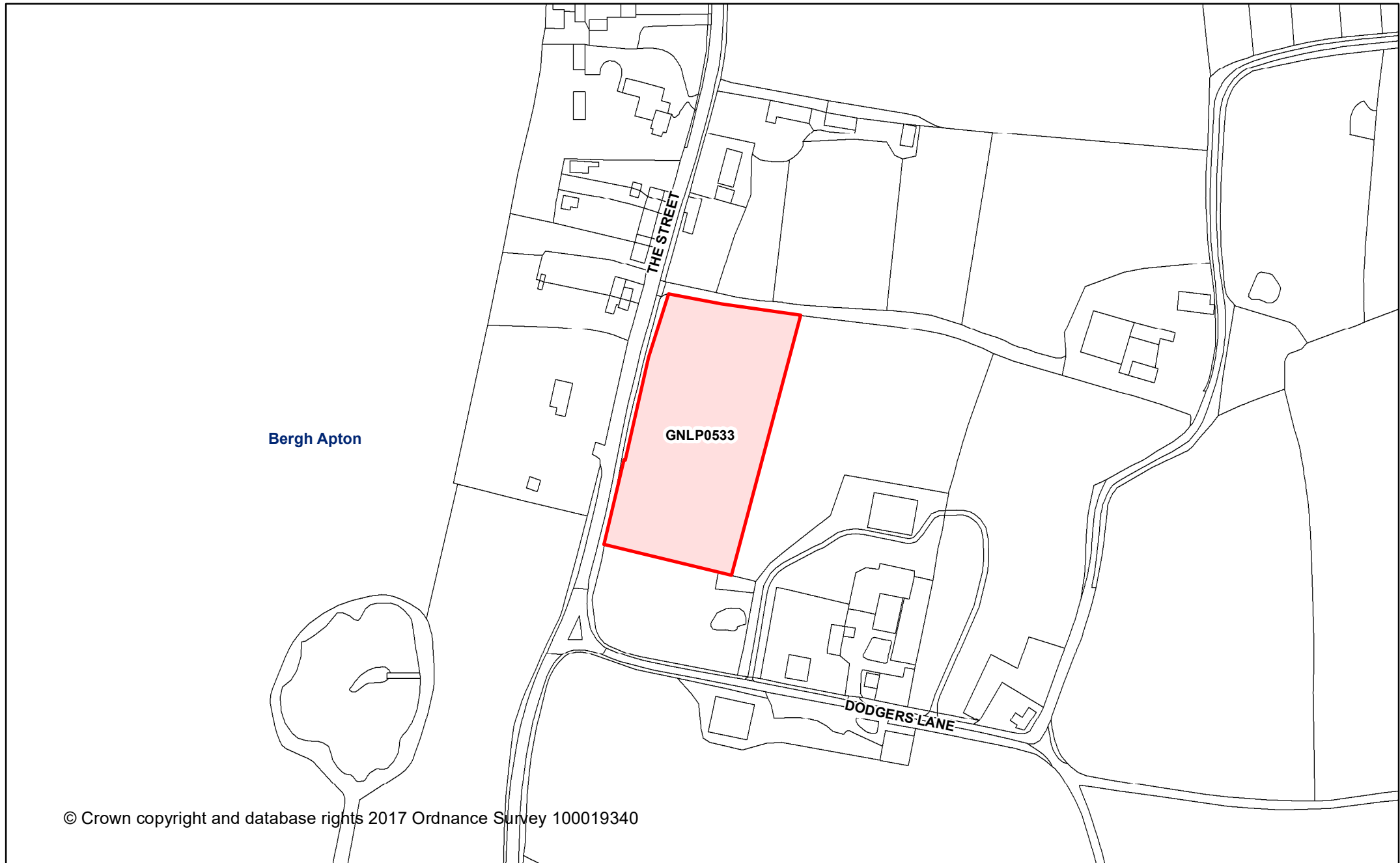

© Crown copyright and database rights 2017 Ordnance Survey 100019340

Greater Norwich Local Plan

Bergh Apton
GNL0533
East of the Street,

Date created:
31-03-2017

Legend 1:2,000

 Parish Boundary



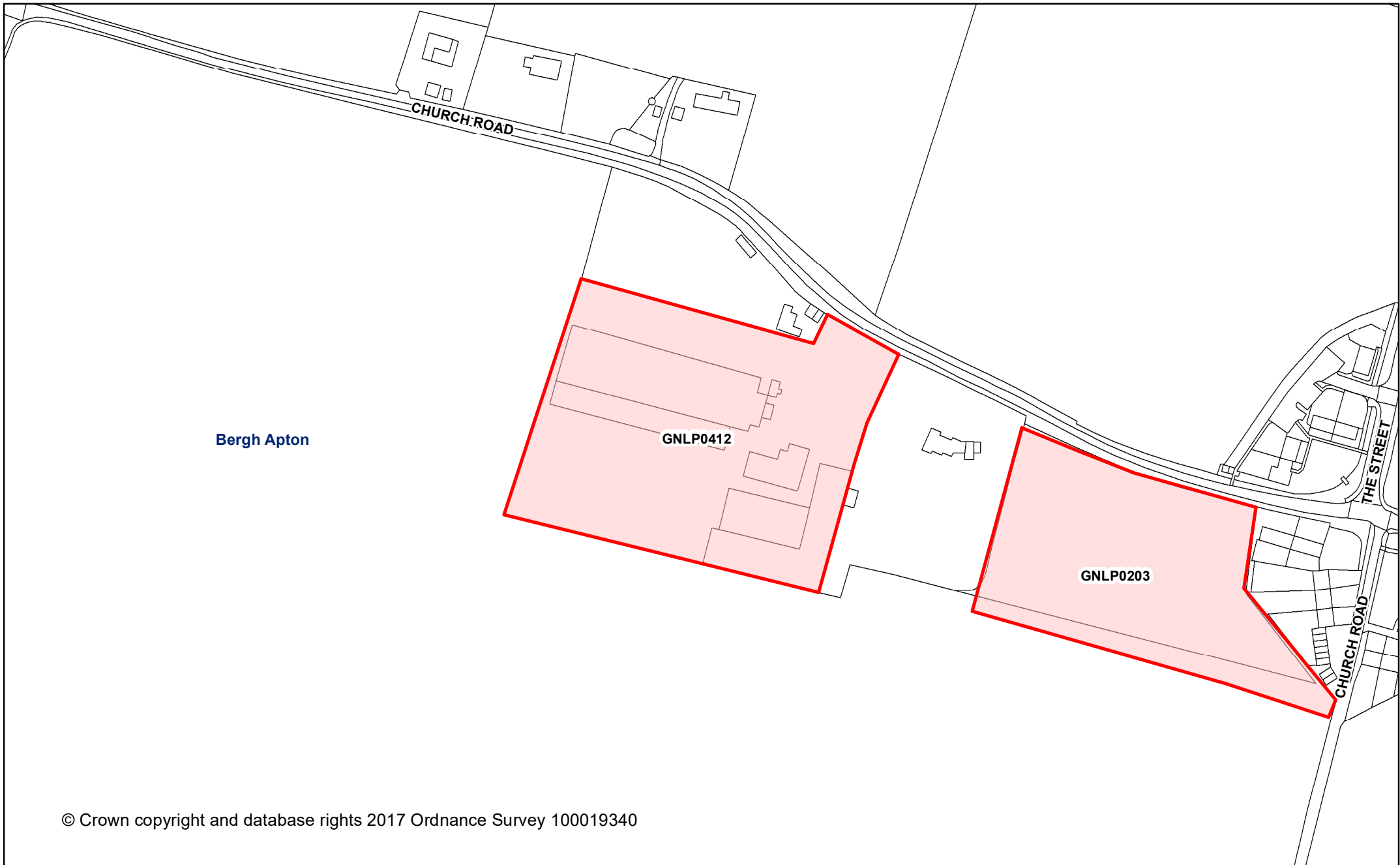

Bergh Apton

GNL0412

GNL0203

© Crown copyright and database rights 2017 Ordnance Survey 100019340

Greater Norwich Local Plan
This map was made by the Norfolk County Council Information Exploitation Team gis@norfolk.gov.uk

Bergh Apton
GNL0412
Former concrete works site. Church Road

Date created:
31-03-2017
Legend 1:2,000
 Parish Boundary





© Crown copyright and database rights 2017 Ordnance Survey 100019340

Greater Norwich Local Plan

Bergh Apton
GNLP0210
Church Wood, Welbeck Road

Date created:
31-03-2017

Legend 1:2,000

 Parish Boundary



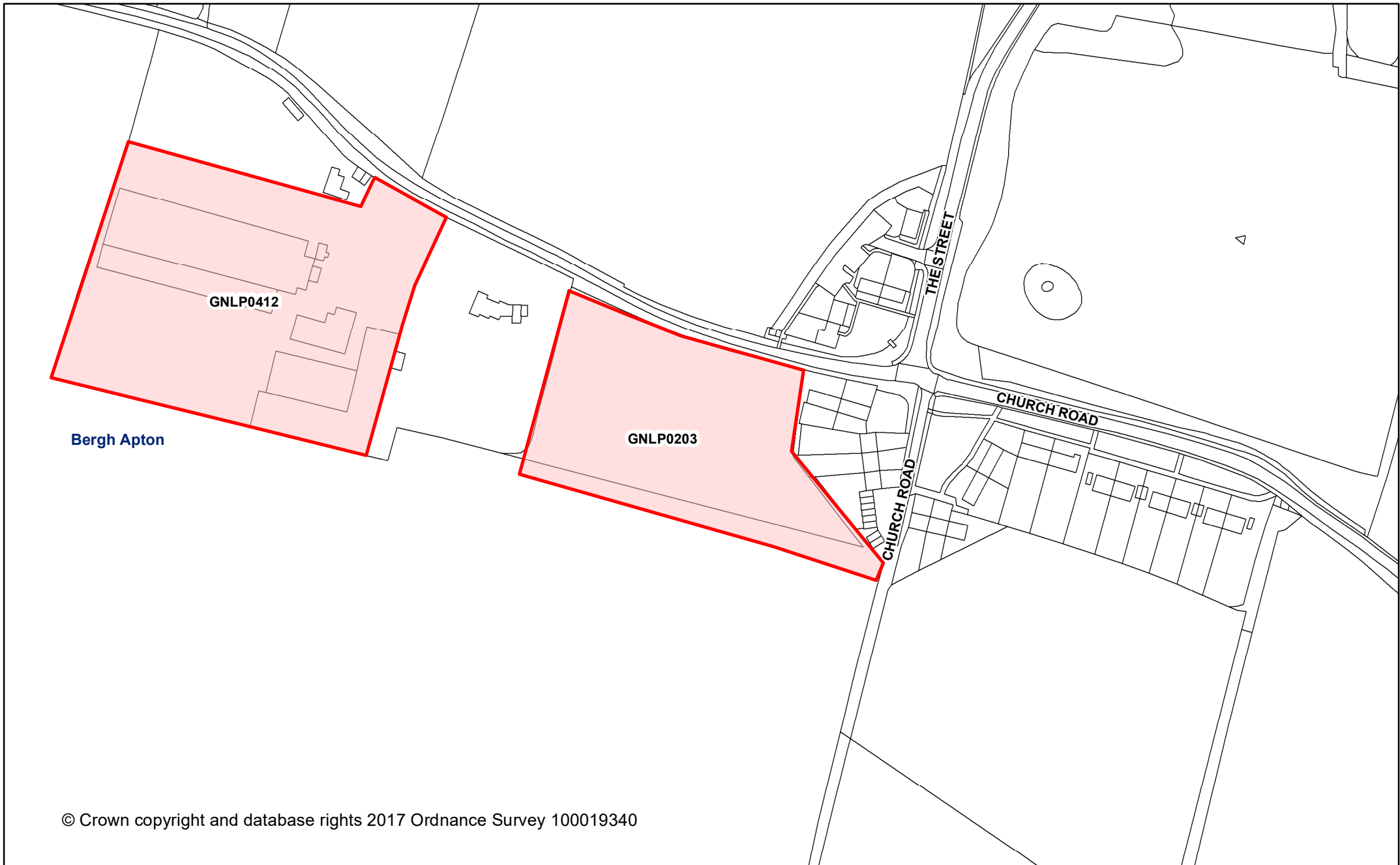

© Crown copyright and database rights 2017 Ordnance Survey 100019340

Greater Norwich Local Plan

**Bergh Apton
GNL0203**

Land to the south of Church Road

Date created:
31-03-2017

Legend 1:2,000

 Parish Boundary





Bergh Apton

GNLP0122

© Crown copyright and database rights 2017 Ordnance Survey 100019340

Greater Norwich Local Plan

Bergh Apton
GNLP0122
Site at Cooke's Road

Date created:
31-03-2017

Legend 1:2,000

Parish Boundary

