

© Crown copyright and database rights 2017 Ordnance Survey 100019340

Greater Norwich Local Plan

Buxton with Lammas

Legend

 ParishesBoundary

Date created:
31-03-2017

1:23,106



This map was made by the Norfolk County Council Information Exploitation Team gis@norfolk.gov.uk

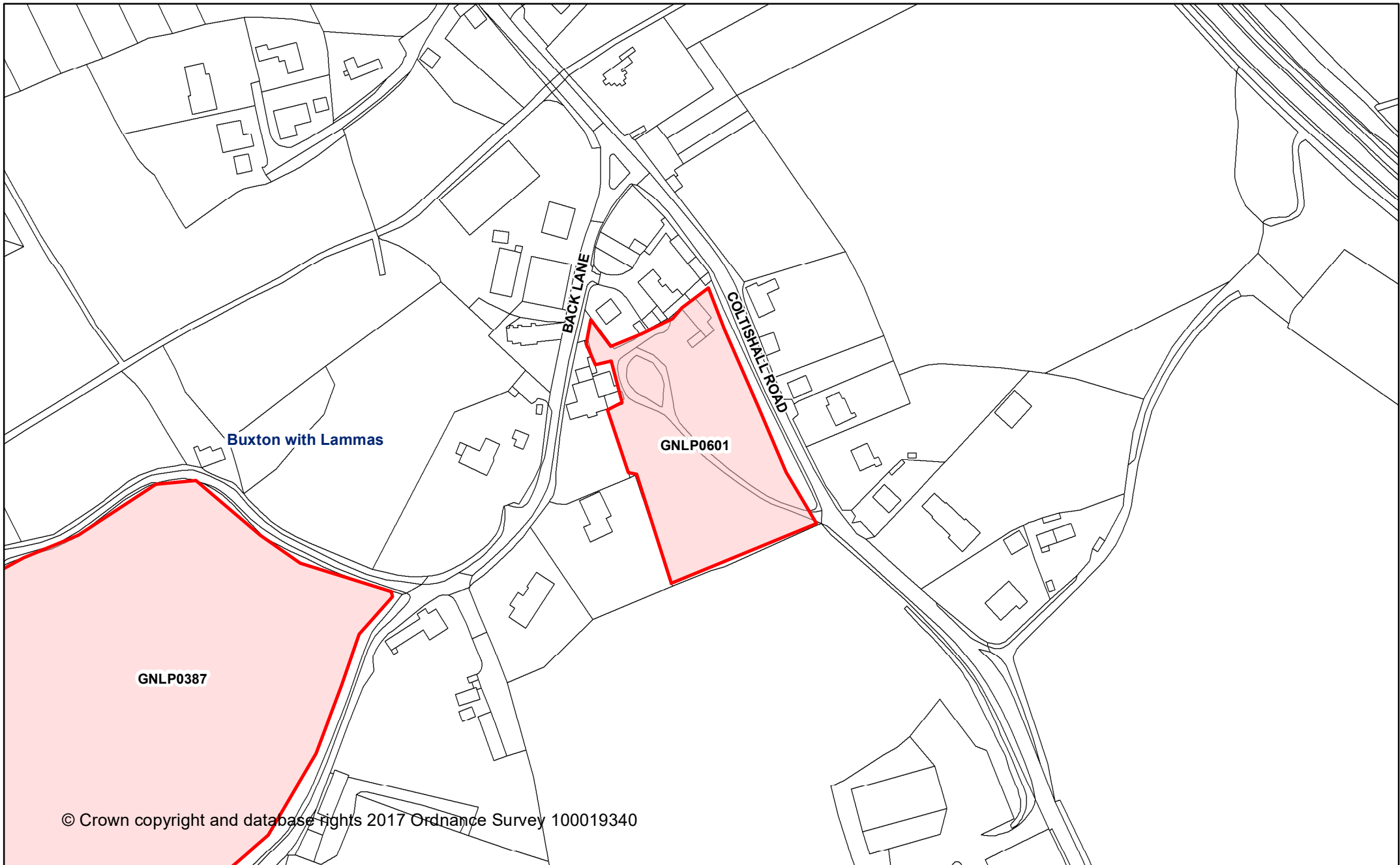

Greater Norwich Local Plan

Buxton with Lammas
GNLP0601
Land west of Coltishall Road

Date created:
31-03-2017

Legend 1:2,000

 Parish Boundary



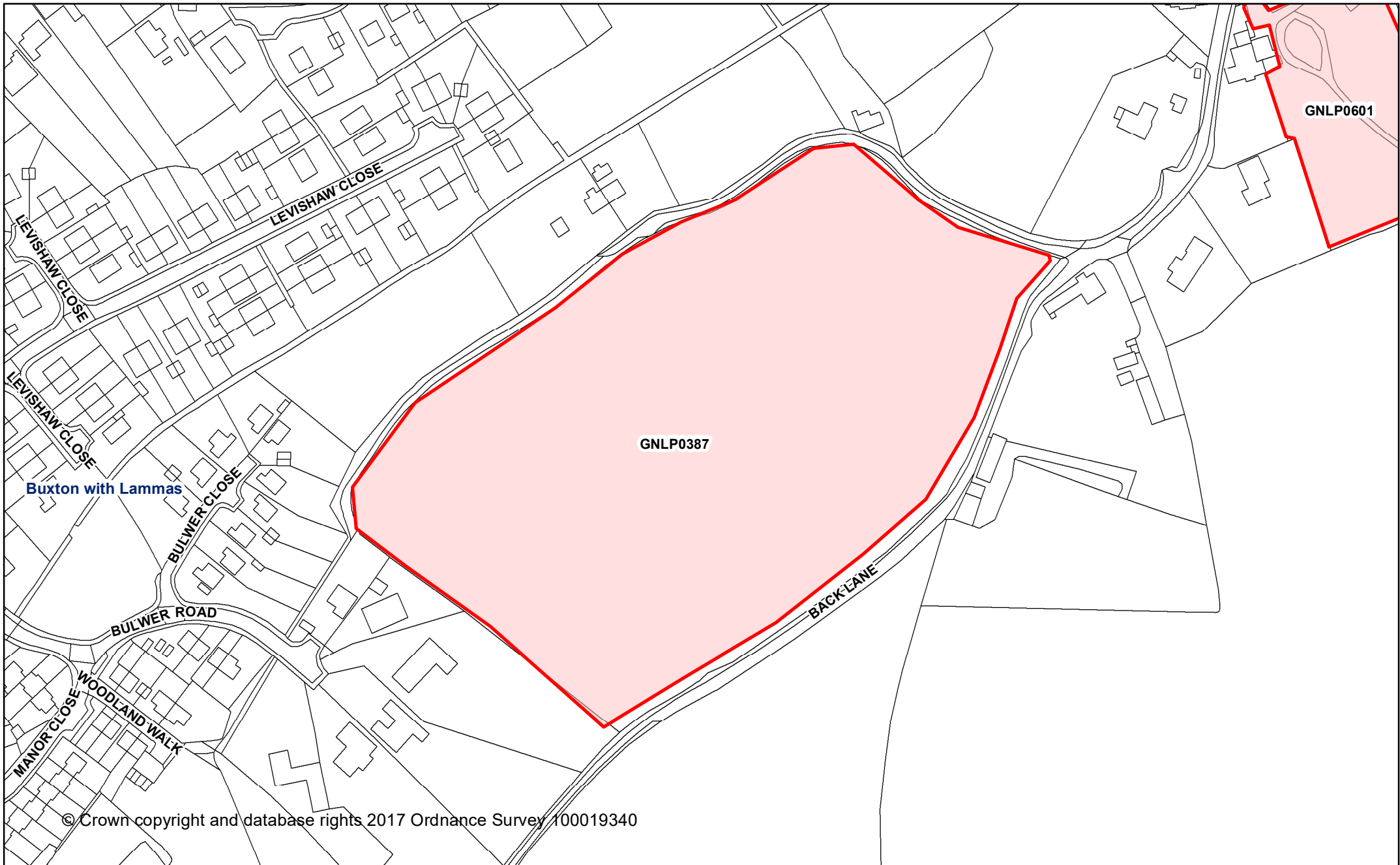

© Crown copyright and database rights 2017 Ordnance Survey 100019340

Greater Norwich Local Plan

Buxton with Lammas
GNLP0387
Back Lane, Buxton

Date created:
31-03-2017

Legend 1:2,000

 Parish Boundary



This map was made by the Norfolk County Council Information Exploitation Team gis@norfolk.gov.uk

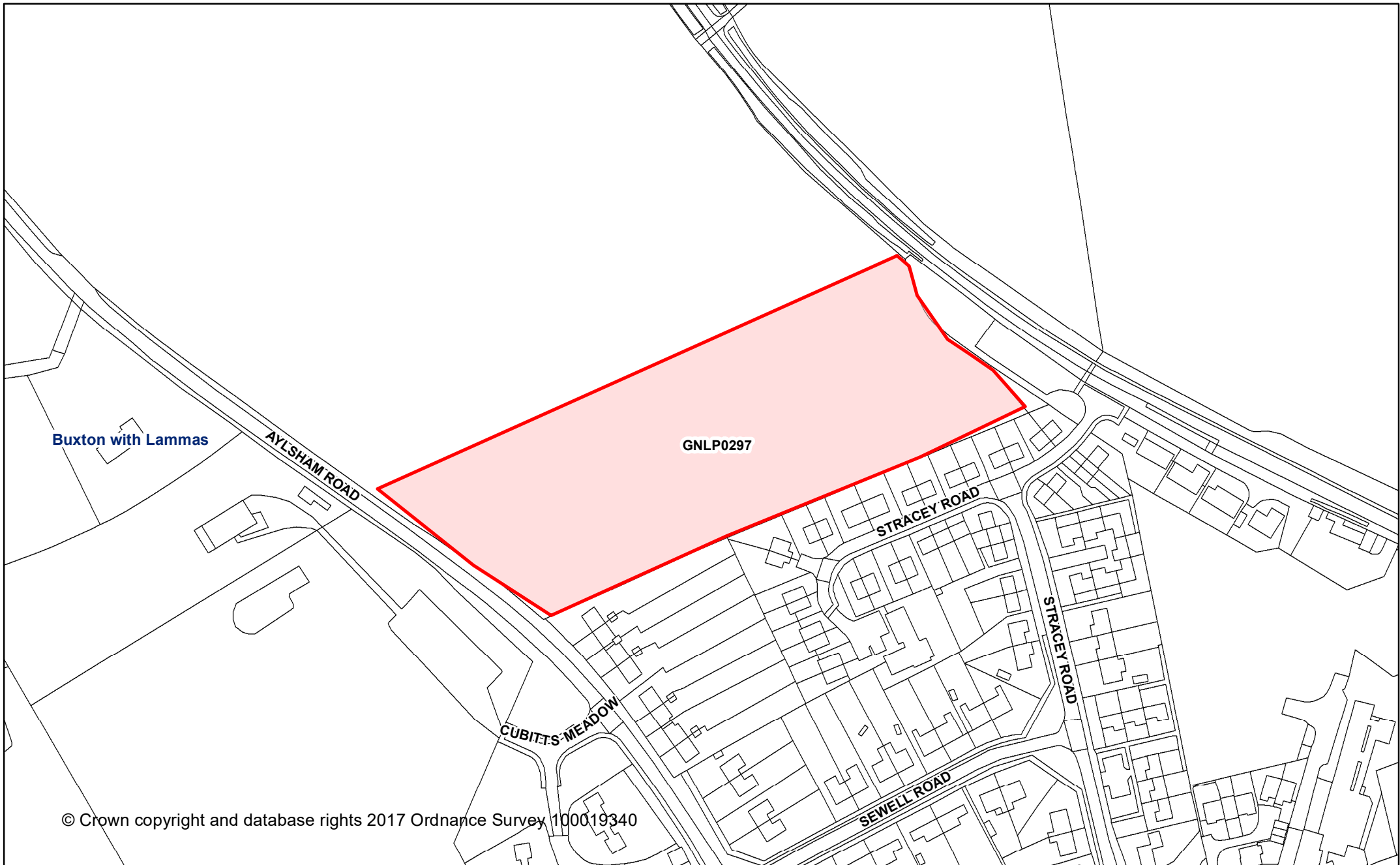

Buxton with Lammas

GNL0297

STRACEY ROAD

STRACEY ROAD

CUBITS MEADOW

SEWELL ROAD

AYLSHAM ROAD

© Crown copyright and database rights 2017 Ordnance Survey 100019340

Greater Norwich Local Plan

Buxton with Lammas
GNL0297

Land to east of Aylsham Road

Date created:
31-03-2017

Legend 1:2,000

 Parish Boundary



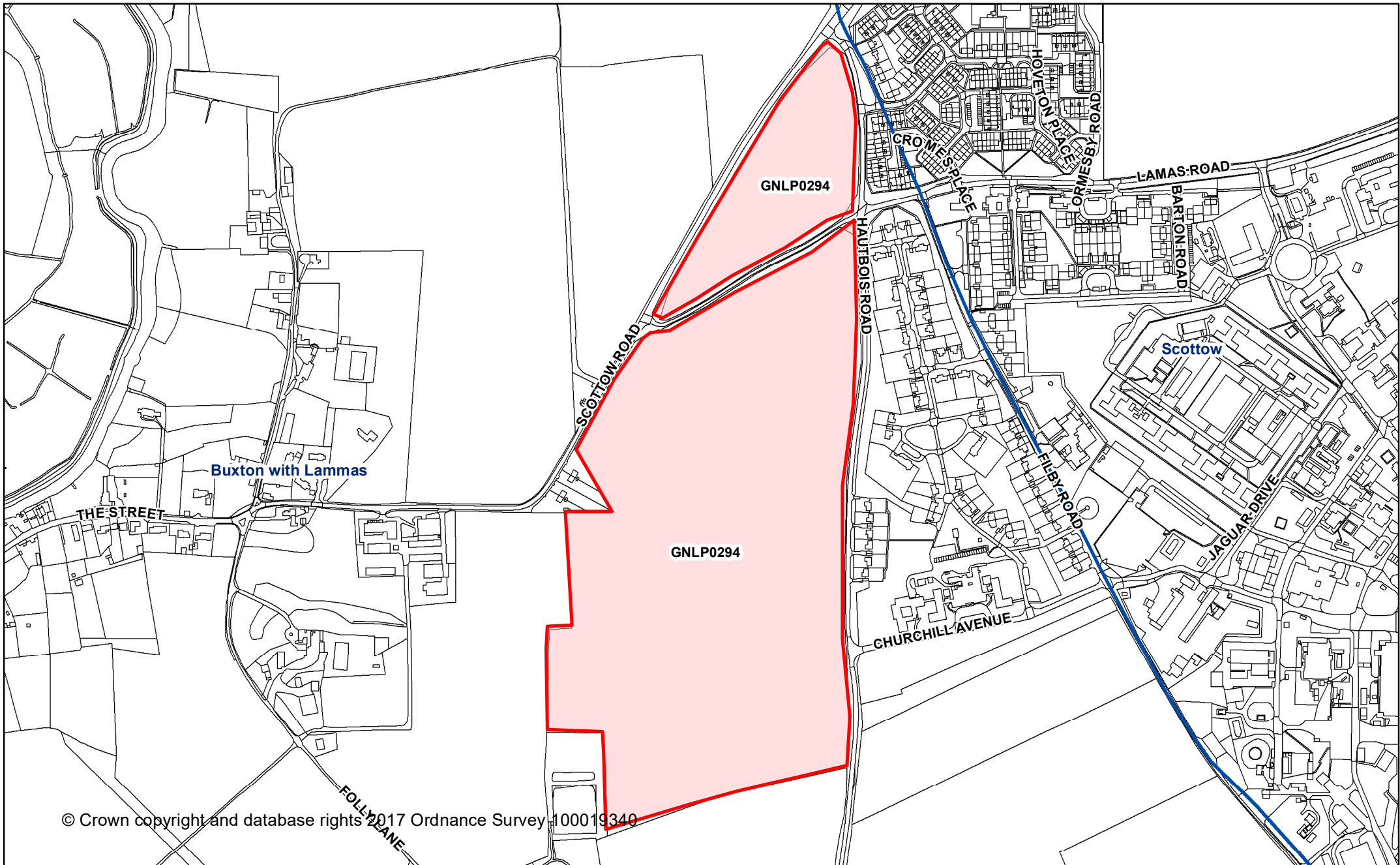

© Crown copyright and database rights 2017 Ordnance Survey 100019340

Greater Norwich Local Plan

Buxton with Lammas
GNLP0294
Land off Scottow Road, Badersfield

Date created:
 31-03-2017

Legend 1:6,097

 Parish Boundary



This map was made by the Norfolk County Council Information Exploitation Team gis@norfolk.gov.uk