

Mr Simon Osborne
The Programme Officer
Joint Core Strategy
1 Lower Farm Cottages
Puttock End
Belchamp Walter
Sudbury
Suffolk
CO10 7BA

6th October 2010

Dear Mr Osborne

AYLSHAM HIGH SCHOOL PROPOSED EXPANSION

SIR WILLIAMS LANE, AYLSHAM

We write with regard to the forthcoming Examination into the submitted Joint Core Strategy Development Plan Document.

Aylsham High School currently accommodates 1020 students in years 7-11. Aylsham High is a popular school with an excellent reputation within the wider community and this year we achieved the second highest results in Norfolk in GCSE examinations. We are also currently exploring Trust status as part of our plans to formalise the work of the Aylsham Cluster of schools. The Aylsham Cluster is held nationally and locally to be an exemplar of cross-phase collaborative working. If the Cluster is successful in acquiring a Trust it is hoped that it will be completed by February 2011.

There have been previous expansion plans for the school, and the Broadland Local Plan 2006 contains a policy (AYL9) which identifies an area of land adjacent to the school to be allocated for outdoor playing purposes with a new access from Sir Williams Lane. However, these expansion plans have yet to be realised. These plans were advanced because the school had already expanded and the local authority had identified a significant shortfall in play space.

With the prospect of new residential development in Aylsham adjacent to the site, we consider there is a now real opportunity of working to deliver our ambitions for expansion and the school is now actively working with a developer to deliver the following:

- As part of a wider "Community Sports Village" concept linked to existing facilities at the school and at the Aylsham Recreation Ground:
 - Community fitness facilities in a fitness suite linked to the existing community sports hall;
 - Delivery of a new full sized football pitch for school and community use;
 - A refurbished swimming pool to improve community access;
 - An astro-turf hockey pitch or full sized 3G football pitch (depending on local demand) for school and community use ;
 - Access to the River Bure for water sports and educational activities.

- New car parking facilities to alleviate current capacity issues; and

- Possible development of a new post 16 campus to provide greater capacity for the whole of the wider Broadland and North Norfolk area;

It is our aspiration that the proposals for expansion will enable the school to become one of the focal points for the community of Aylsham and the wider region.

Proposals are currently being worked up in detail as part of the identified housing allocation for 300 units in Aylsham which, if successful, will see a substantial area of land transferred to the school.

We trust this correspondence is of use in confirming that we support the identified expansion of Aylsham as a main town within the Joint Core Strategy.

Yours sincerely

Mr Duncan Spalding
Head Teacher Aylsham High School

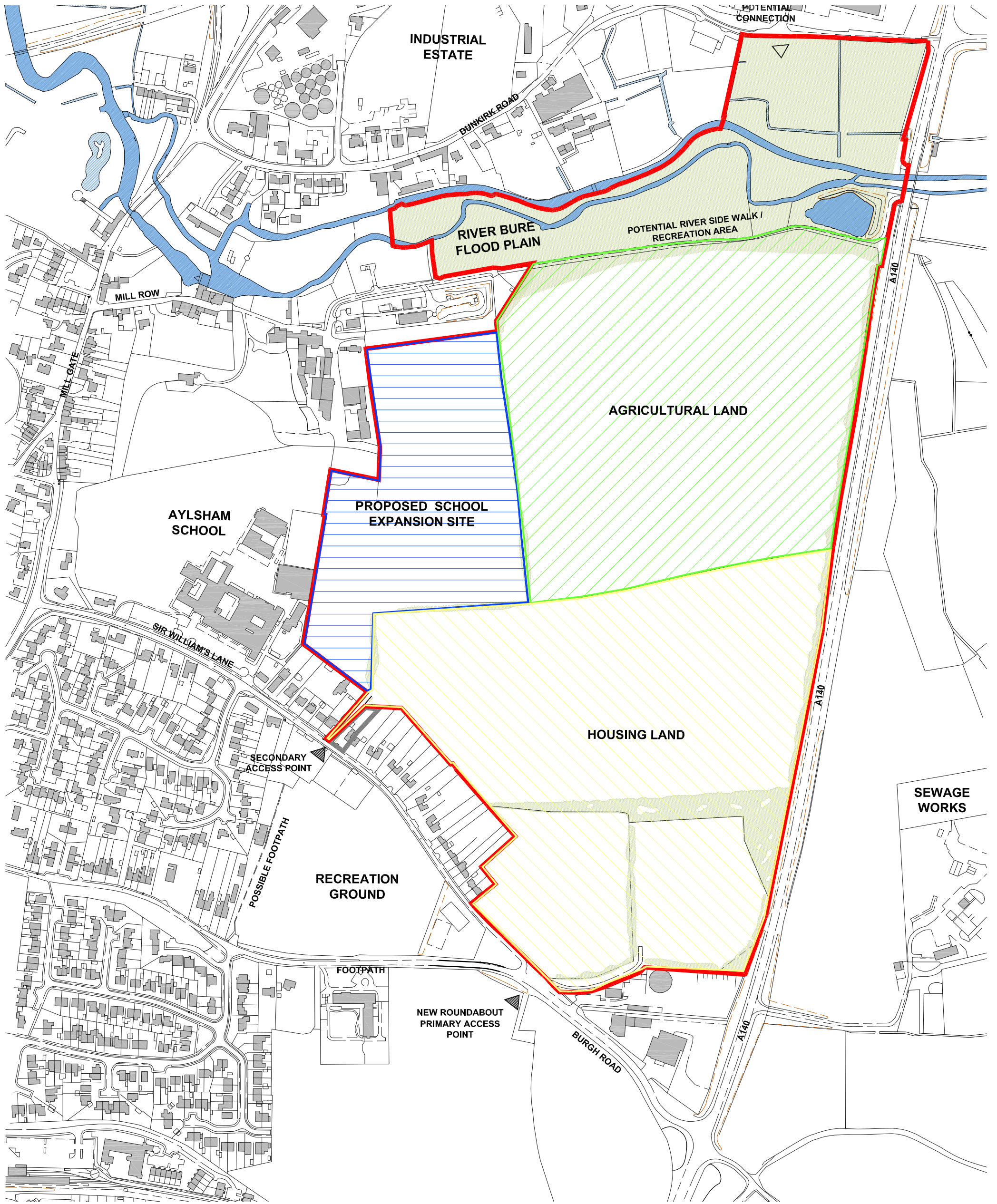

AYLSHAM , NORFOLK

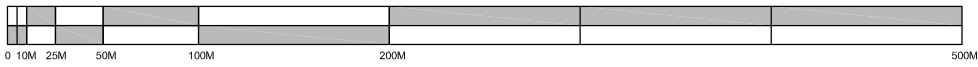

NOTES:

USE FIGURED DIMENSIONS ONLY
DO NOT SCALE FROM THIS DRAWING.

ALL DIMENSIONS MUST BE CHECKED ON SITE ANY
INCONSISTENCIES MUST BE REPORTED BACK TO THE ARCHITECT.

THIS DRAWING AND ANY DESIGNS INDICATED THEREON ARE THE
COPYRIGHT OF BROOKS / MURRAY ARCHITECTS.
ALL RIGHTS ARE RESERVED.
NO PART OF THIS WORK MAY BE PRODUCED WITHOUT PRIOR
PERMISSION IN WRITING FROM BROOKS / MURRAY ARCHITECTS.

DRG NO: 797/SCH/01

DATE: 06.10.2010

SCALE: 1:5000@A3

TITLE:

LAND AT SIR WILLIAM'S LANE, AYLSHAM.

PROPOSED AYLSHAM HIGH SCHOOL NEW
CAMPUS AND HOUSING DEVELOPMENT.

BROOKS / MURRAY

ARCHITECTS

8-10 NEW NORTH PLACE
LONDON EC2A 4JA

TEL 020 7739 9955
FAX 020 7739 9944

architects@brooksmurray.com